

C310412

310412-SM-CC-EC-VV

ITEM NO.	PART NUMBER	DESCRIPTION	QTY.
1	01-0201	LOCKWASHER, REGULAR, 5/16, ZINC	8
2	01-0706	SCREW, 5/16-18 X .75 ZN	8
3	01-2023-2	SCREW, RIVET, #2 X .188, SS	2
4	03-1179	BODY, P/P SOL. ADAPTOR	1
5	03-1180	EXHAUST ADAPTOR	1
6	03-4001	NAMEPLATE, SERIES 20 SOL. OPP.	1
7	04-01-010	O-RING, BUNA 70, #010	1
8	20-1889	NAME PLATE, TUBE-O-MATIC	1
9	20-1892	BODY, 3/4, 1 NPT, T-O-M	1
10	SEE TBL (CC)	CENTER CORE	1
11	SEE TBL (EC)	END CAP	2
12	SEE TBL (SM)	SLEEVE	1
13	SEE TBL (VV)	SOLENOID ASSY	1

NOTES:

1. PILOT PRESSURE TO MEDIA PRESSURE RATIO: 1:1.
2. OPERATING PRESSURE: 150 PSI MAX.
3. TEMPERATURE RANGE: -30° F TO 225° F.
4. PRIMARY OPERATOR: DIRECT SOLENOID OPERATOR.
5. SERVICE MEDIA: LIQUIDS AND INERT GASES.
6. SLEEVE MATERIAL: SEE TABLE SLEEVE MAT. OPTIONS (SM) FOR ALL OTHERS CONSULT THE FACTORY.
7. SOLENOID VOLTAGE: AC OR DC.
8. FOR MAXIMUM SLEEVE LIFE, THE PILOT TO MEDIA PRESSURE DIFFERENTIAL, SHOULD NOT EXCEED 20 PSI. FOR MEDIA PRESSURE BELOW 50 PSI, THE PILOT PRESSURE IS MEDIA PRESSURE PLUS 15 PSI.

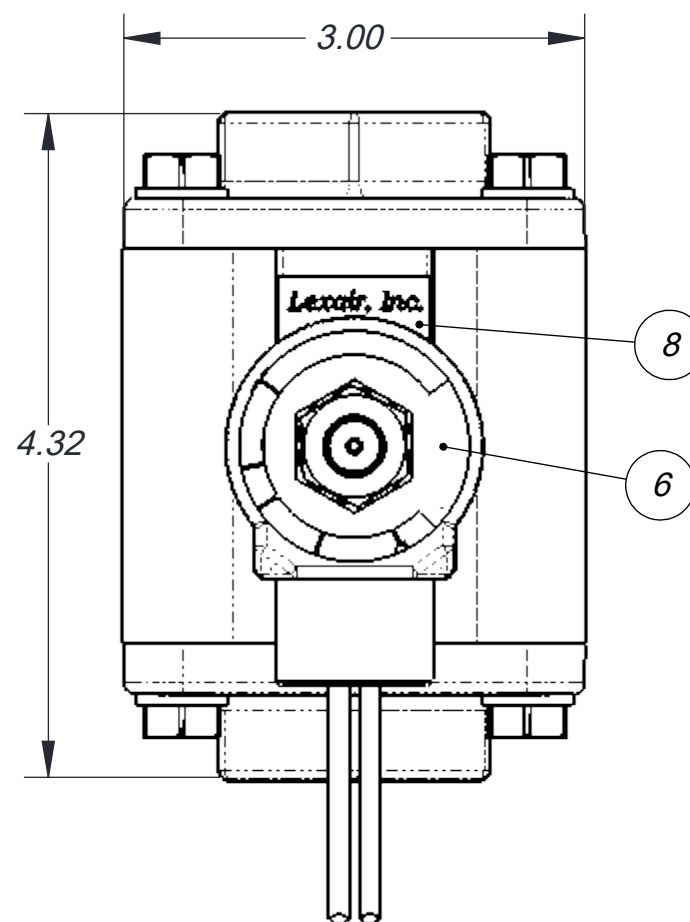

SLEEVE MATERIAL OPTIONS (SM)

CODE	MATERIAL	PART NO.
STD	BUNA - N	20-1073
26	VITON	20-1074
29	EPR	20-1075

CENTER CORE OPTIONS (CC)

CODE	MATERIAL	PART NO.
STD	NI PLT BRASS	20-1095
43	PVC	20-1342
45	316 STNLESS	20-1110
46	TEFLON	20-1107

END CAP OPTIONS (EC)

CODE	MATERIAL	PART NO.
STD	NI PLTD BRNZE	20-1084
57	PVC	20-1082
59	316 STNLESS	20-1087

SOLENOID OPTIONS (VV)

CODE	VOLTAGE	PART NO.
-1	120V/60Hz	03-3701
-2	240V/60Hz	03-3702
-3	480V/60Hz	03-3703
-4	6V DC	03-3704
-5	12V DC	03-3705
-6	24V DC	03-3706
-7	24V/60Hz	03-3707

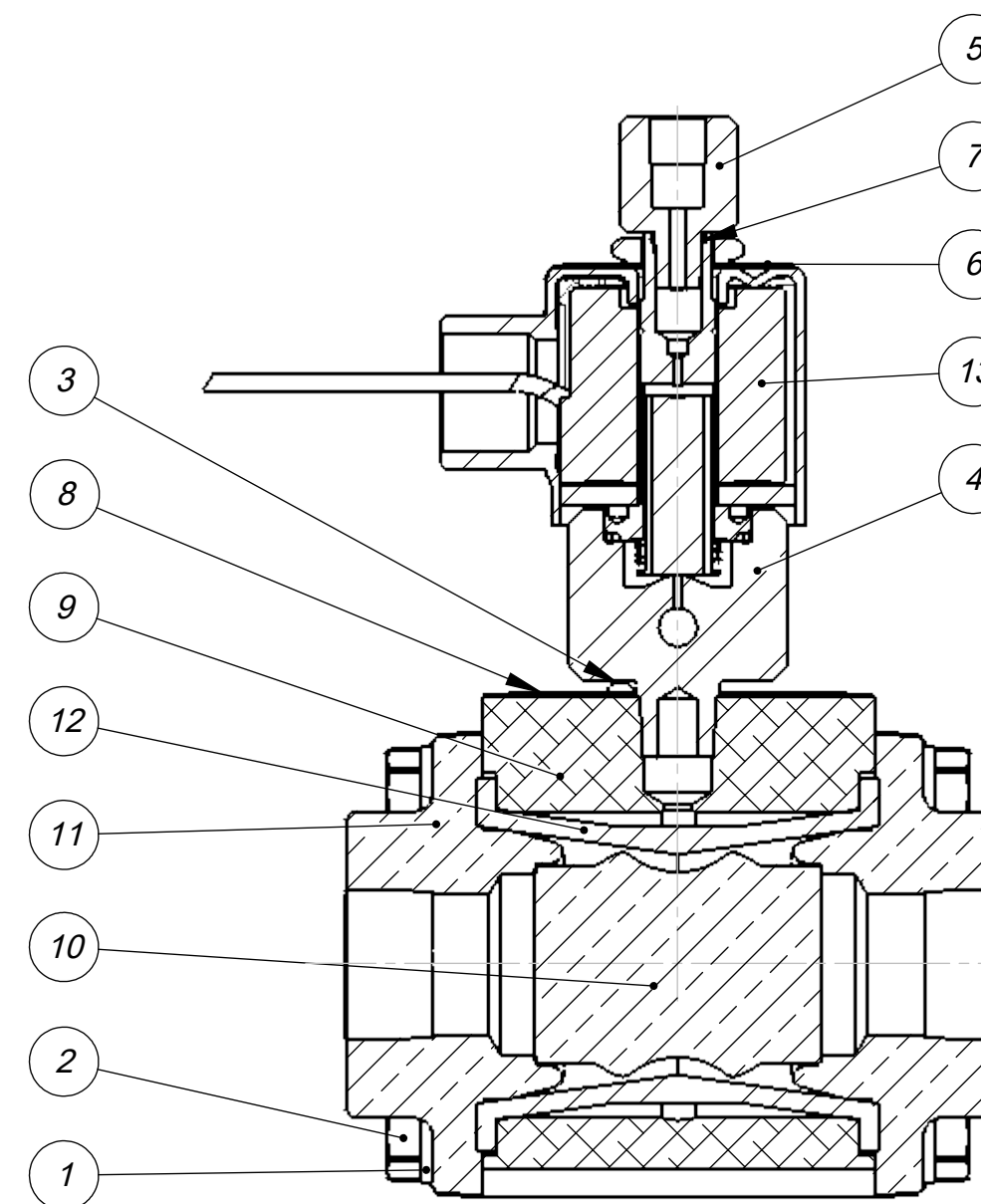
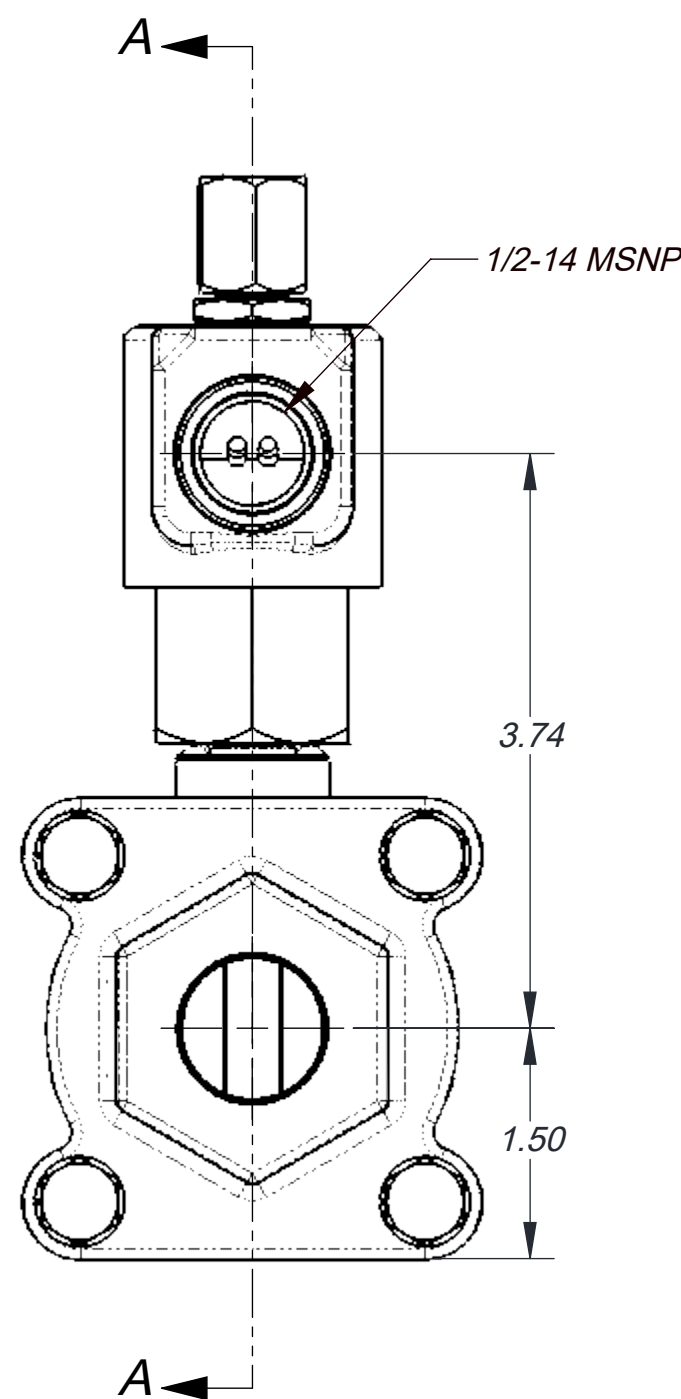
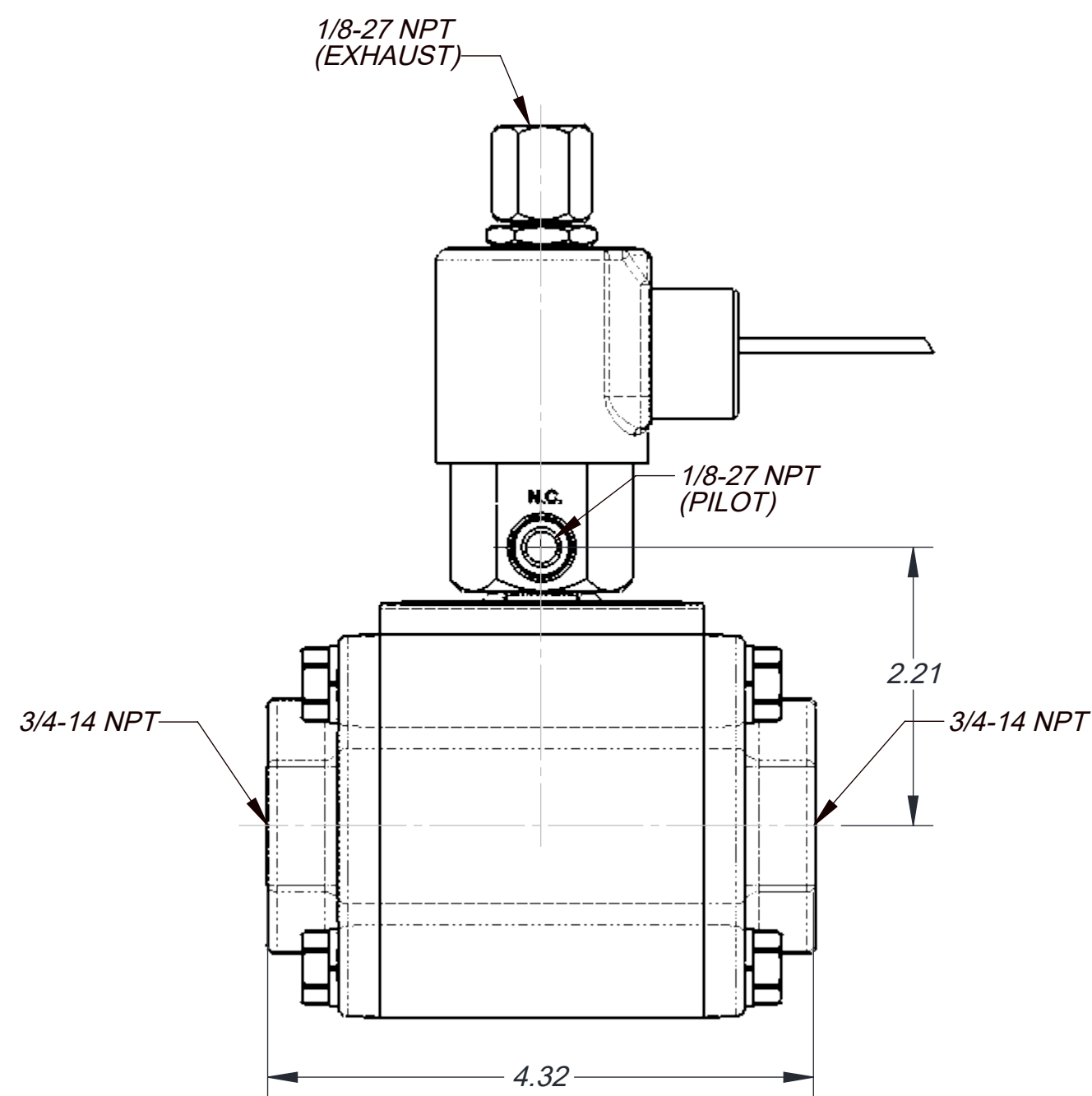

SECTION A-A
SCALE 1 : 1.25

THIS DOCUMENT AND ITS CONTENTS ARE THE PROPERTY OF LEXAIR, INC. THEY ARE FURNISHED TO YOU ON THE FOLLOWING CONDITIONS: NO RIGHT OR LICENSE IN RESPECT OF THIS DOCUMENT OR ITS CONTENTS IS GIVEN OR WANTED IN SUPPLYING THIS DOCUMENT TO YOU. THIS DOCUMENT OR ITS CONTENTS ARE NOT TO BE USED OR TREATED IN ANY MANNER INCONSISTENT WITH THE RIGHTS OF LEXAIR, INC. OR TO ITS DETRIMENT AND ARE NOT TO BE COPIED, REPRODUCED, OR DISCLOSED OF, EXCEPT WITH ITS PRIOR WRITTEN CONSENT.

REVISIONS

- PREVIOUS REVS. OMITTED.
- B REDRAWN TO CURRENT ENG. STDS. ECL: 06113 10-16-06 HWP TPO
- C REDRAWN TO CURRENT ENG. STDS. ECL: 21032 06-22-21 TES

Tolerances Unless Otherwise Specified:

TYPE	FINISHED	AS CAST
DEC .00	± .015"	± .030"
DEC .000	± .005"	± .010"
FRACTIONAL	± 1/64"	± 1/32"
ANGLES *	± 1/2°	± 1°

FINISH 175 µ in.

MATERIAL SPEC.
SEE TABLE

PROCESS SPEC.
SEE TABLE

PC. NO.: 310412-X
MADE FROM:
MODEL FILE: 310412.SLDASM
CAD FILE: 310412.slddrw

SO, T-O-M, 3/4" NPT

Lexair, Inc.
2025 Mercer RD, Lexington, Kentucky 40511

DRAWN	CHECKED	APRVD.	SHEET NO.	SHEETS
HWP	HWP	HWP	1 of 1	
10-16-06	10-16-06	10-16-06	SCALE 1:1	
			APPROX. WT. 5.572 lbs.	